



## BATHTUB MIXER

BM 366629



### Specifications

BRAND	BELLA	PRODUCT TYPE	BATHTUB MIXER
RANGE	PREMIUM	COLOR/FINISH	BRUSHED GOLD, CHROME, MATTE BLACK & SHINY ROSE GOLD
PRODUCT CODE	BM 366629	MATERIAL	BRASS

### Drawing

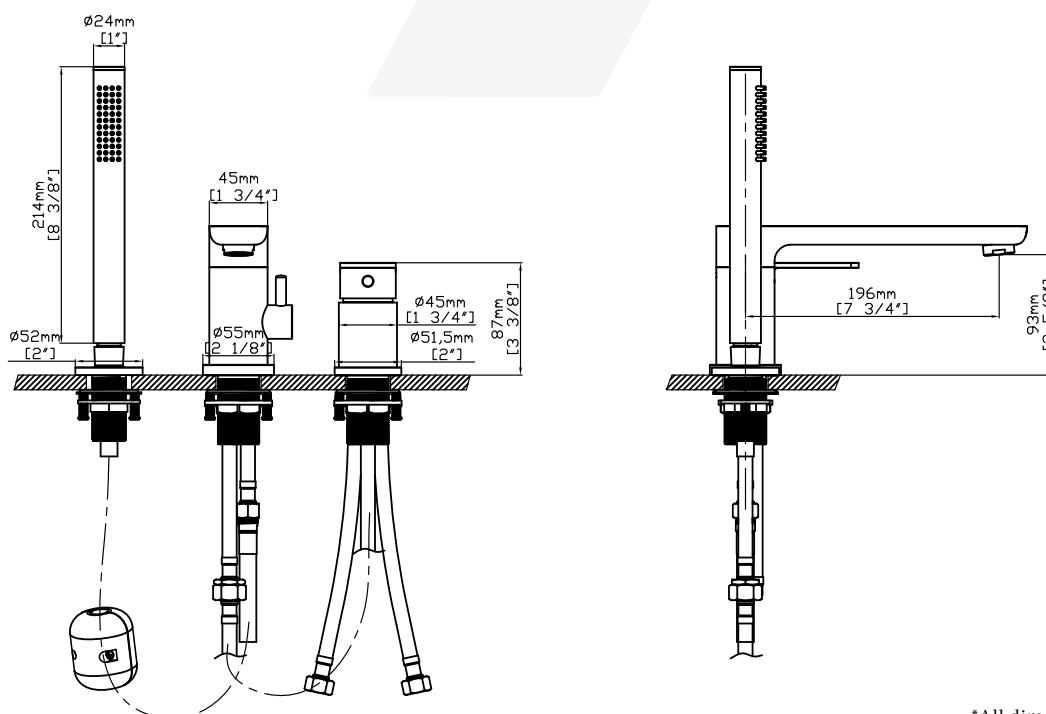

\*All dimensions are in mm

## INSTALLATION MANUAL Tools You Will Need :

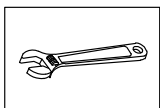

Adjustable wrench

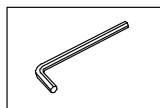

Hexagon wrench

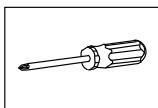

Philips Screwdriver

### Notes before installation :

1. Please check that all components are present.
2. Before installation ensure that all feed lines are clear of debris and on/off valve is present.
3. Ensure water pressure is between 0.1-8 BAR (includes combination of hot and cold feed lines).
4. Pictures in the manual are general in content and may not represent exactly your purchased faucet. If you are having difficulties please contact a professional plumber.
5. If you will be away from home for an extended period you should shut off the main water supply.

### Daily maintenance

1. Use a soft cloth and vinegar to remove hard-water spots.
2. Check aerator (if present) regularly for calcium build up are when water stream is not optimum.
3. DO NOT use caustic cleaning products as the use will break down finish and will void the product warranty.
4. Acceptable cleaners include vinegar or mild non-abrasive liquid detergents.
5. If the water pressure appears to be less than optimum remove, inspect, clean or replace aerator.

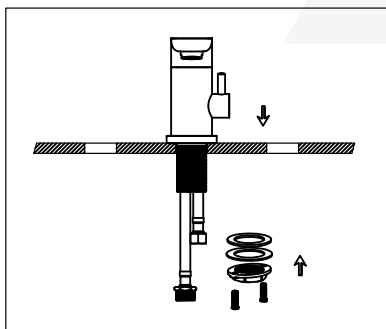

1. Remove the lock nut and washer from the spout body. Place spout in middle hole of sink. Assemble washer and tighten the lock nut to it.

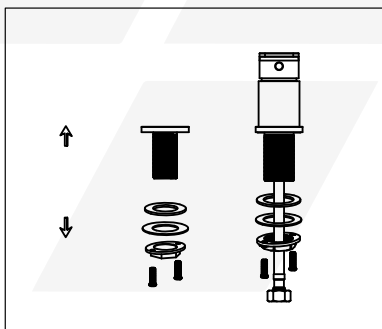

2. Remove the rubber washer, metal washer and lock nut from the faucet.

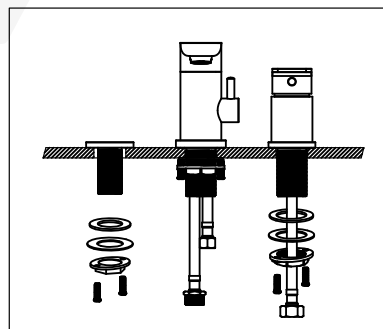

3. Place the valve control to the hole of sink and hand shower holder through left hole. Assemble the rubber washer, washer and tighten with lock nut.

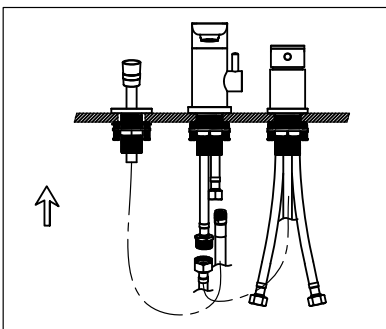

4. Screw and hand tighten the hot and cold flexible hoses to the faucet. DO NOT use a wrench to tighten hoses as this may damage the hose and/or the hose threads.

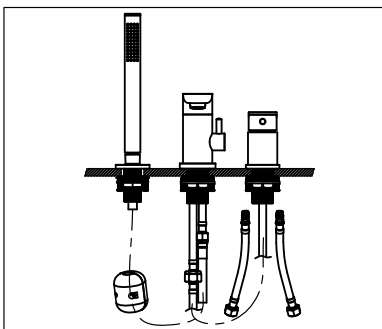

5. Screw and hand tighten the head shower hoses, weight kit to the faucet. DO NOT use a wrench to tighten hoses as this may damage the hose.

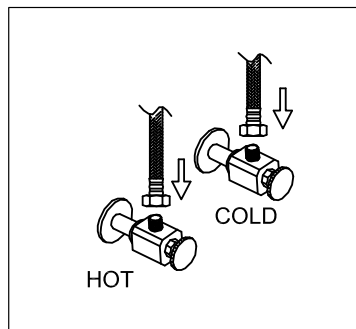

6. Attach flexible hose to water supply.